

You must be fully aware of all the distinctive features and precautions related to this camera before installing it.

COMPOSITION:

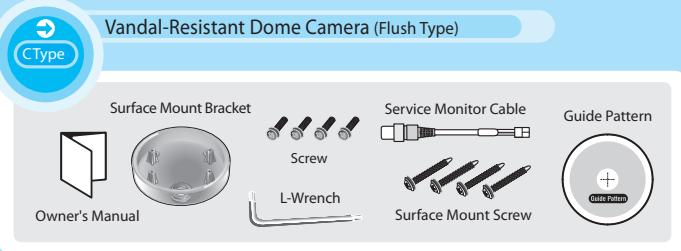

**Denmark Head Office**  
Ernitec A/S  
Phone: +45 44 50 33 00  
Fax: +45 44 50 33 33  
info@ernitec.dk

**France Branch Office**  
Ernitec France  
Phone: +33(0)467151015  
Fax: +33(0)467640181  
info@ernitec.fr

**German Branch Office**  
Ernitec GmbH  
Phone: +49(0)40)6756250  
Fax: +49(0)40)67562525  
info@ernitec.de

**UK Branch Office**  
Ernitec UK  
Phone: + 44 (0) 190 326 31 25  
Fax: + 44 (0) 190 326 31 26  
info@ernitec.co.uk

**Middle East Office**  
Ernitec ME  
Phone: +961 1 751 796  
Fax: +961 1 751 795  
info@ernitecme.com

www.ernitec.com



This device complies with Part 15 of the FCC Rules. Operation is subject to the following two conditions: (1) This device may not cause harmful interference, and (2) this device must accept any interference received, including interference that may cause undesired operation.

SPECIFICATIONS:

Model	PAL
Signal System	PAL : 625 Lines
Scanning System	2 : 1 Interlace
Scanning Frequency (H)	15.625KHz
Scanning Frequency (V)	50Hz
Image Sensor	1/3 inch SONY IT CCD
Total / Effective Pixels No.	470K
S/N Ratio	50dB Min. (AGC Off)
Resolution	550 TV Lines
Video Output Level	1.0 Vp-p (75 Ohms, composite)
Lens	Vari-focal Lens (f=3.8~9.5mm)
Focus	Manual
Sync. System	Internal
Sensitivity (F1.2)	0.3 Lux(color)/ 0.1 Lux(B/W)/ 0.008 Lux(DSS On, x32)/ 0 Lux(IR LED)
Electronic Shutter	1 /50 ~ 120,000 Sec.
White Balance	Auto
AGC/ BLC/ D&N/ FL	On / Off Selectable
DSS	Max 32 FLD (On / Off)
D-ZOOM	2 x (On / Off) w. Dip Switch
DNR	AUTO
Input / Output Connector	Power, Video
Operating Temperature	-10° C ~ 45° C
Storage Temperature	-20° C ~ 65° C
Power Consumption	DC 12V (DC 10.8V~13.2V), 4.5 W (Max)
AC 24V	AC 24V (20V~28V), 5W (Max)
Dome Size (Ø)	100mm
Weight	Approx. 366 g



User Manual

Mercury/2 VR3V10IRH  
Color Dome

Digital DSP  
Digital Slow Shutter DSS



550TVL



1/3" SONY CCD



LENS Vari-focal



CCD COLOR



AWB Auto White Balance



AGC Auto Gain Control



DSP Digital Signal Processor

Design and specifications are subject to change without notice.

PRECAUTIONS:

- Do not install the camera in extreme temperature conditions. Do use the camera under conditions where temperatures are within -10° C to 45° C. Be especially careful with ventilation under high temperatures.
- Do not install or use the camera in an environment where the humidity is high. It can cause the image quality to be poor.
- Do not disassemble the camera. There are no user-serviceable parts inside it.
- Do not drop the camera or subject them to physical shocks. It can cause malfunctions to occur.
- Note: When this camera is installed near wireless communication devices that emits strong electromagnetic field, irregularity such as noise on the monitor may appear.

NAME AND FUNCTION:

Vari-focal Lens Type

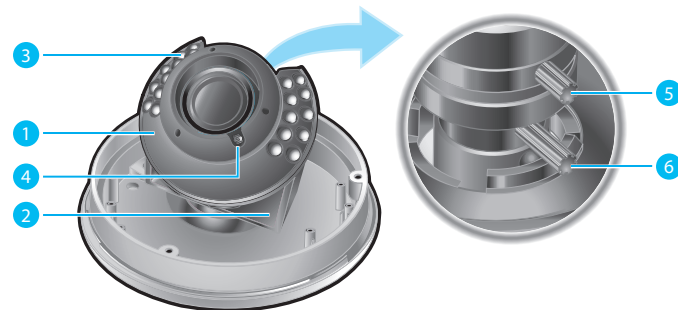

Camera Lay-out

- 1 Tilt rotation: Adjusting the vertical angle.
- 2 Pan rotation: Adjusting the horizontal angle.
- 3 IR LED: 850nm / 30° (20EA)
- 4 Sensor
- 5 Focus handle: Focus (Far or Near)
- 6 Zoom handle: Zoom (Tele or Wide)

CONNECTION:

AC 24V/ DC 12V Power Type

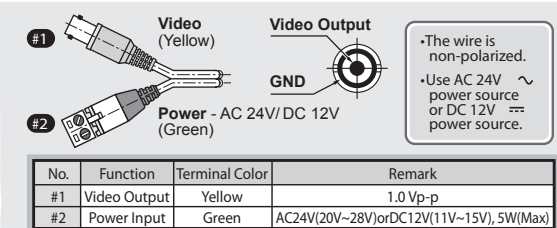

IR LED(3.8mm~9.5mm Vari-focal Lens)

- Power Consumption: 5W
- IR LED Specification: 850nm / 30° (20EA)

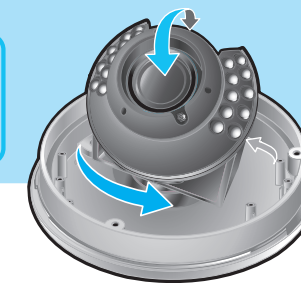

CAMERA SET-UP:

Vari-focal Lens Type

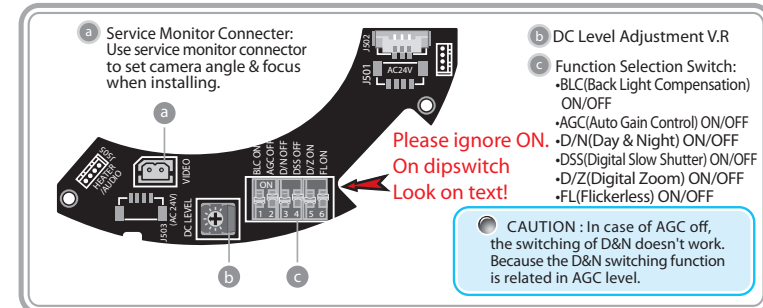

TROUBLESHOOTING:

If you have trouble operating your camera, refer to the following. If the guidelines do not enable you to solve the problem, contact an authorized technician.

- The image does not appear on the screen.
  - Check the power source for the monitor and camera and assure that the voltage and polarity are properly connected and being supplied correctly.
- The image on the screen is dim.
  - Check if the lens is stained. If dirty, clean the lens with a soft, clean cloth.
  - Adjust the Back Focus of the lens again.
- The camera does not work properly, the surface of the camera case is hot, and a black line appears on the screen.
  - Check if you have connected the camera to a proper power source and if there is no problem with the power, turn the unit off immediately and seek assistance from our After Service department.
- The screen blinks a lot.
  - Check if the camera is pointed toward the sun or a fluorescent lamp.
  - Adjust the angle or location of the camera if too much light is coming into the screen.