

# ERIS 3000 H.264



Second generation of Eris 3000 is available in 4/8/ and 16 channels. With a frame rate up to 200 FPS in Cif. It delivers high quality recordings using H.264 compressing which saves room on the network and hard drive ERIS has as standard DVD drive and 4GB USB key with documentation and CMS software. ERIS can connect 2 IP cameras in VGA resolution

**ALARM:** Eris has 4/8/16 alarm inputs and One alarm output it can transmit E-mail notification with attachment

Full screen alarm for both main and spot monitor.

**MOTION DETECTION:** With intelligent motion you can select 1-16 squares shall be activated before a alarm releases.

**CONTROL:** GUI, mouse, web interface and CMS

**AUDIO:** 4/8/16 audio input and audio out separate to Spot and Main monitor

**REMOTE:** CMS streamer 64 pictures from up to 10 sites. You can import E-map drawings of The surveilled area .

**UTP:** Voltage/RS485/video over twisted pair. The UTP version of ERIS reduces installation cost dramatically by transmitting video, RS485 and power in just one single CAT5 cable on a distance up to 300 meter. UTP is plug and play no adjustment at all!

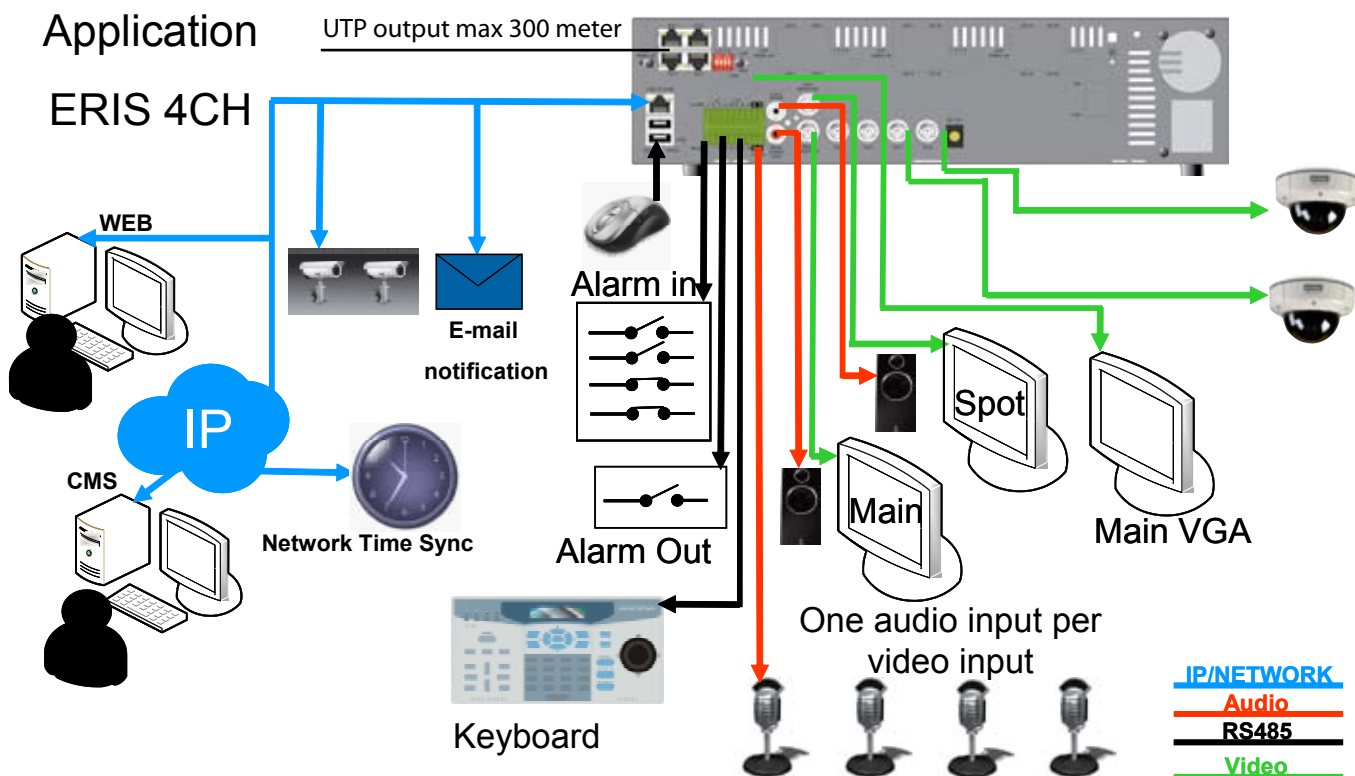

# ERIS3000 H.264

## Specifications and accessories

Article	ERIS3320	ERIS3320 UTP	ERIS3500	ERIS3500 UTP	ERIS31000	ERIS31000/UTP
<b>Video</b>						
Inputs	BNC × 4, 1,0 Vs-s / 75 ohm		BNC × 8, 1,0 Vs-s / 75 ohm		BNC × 16, 1,0 Vs-s / 75 ohm	
UTP	No	4	No	8	No	16
Video functions	Triplex (live/playback, record and network)					
Outputs	Main monitor	BNC × 1, 1,0 Vs-s / 75 ohm				
	Call-monitor	BNC × 1, 1,0 Vs-s / 75 ohm				
	VGA	800 × 600, 1024 × 768, 1280 × 1024 pixels @ 60 Hz				
Live monitor	PAL: 400 PPS (16 channels)					
Digital zoom	2x2					
<b>Audio</b>						
Inputs	Terminal × 4, Line-In		Terminal × 8, Line-In		Terminal × 16, Line-In	
Output	RCA × 2, Main monitor and Spot monitor Line-Out					
Compressions	ADPCM, G.726					
Bit	8 KB/s, pr. Channel 0.7 GB per day					
<b>Recording</b>						
Compressions way	H.264 Advanced profile					
Recording	Calender, alarm, Motion detection with pre-alarm					
Recording way	Best quality, standard, ezrecord, DSL					
Resolution compression	MJPEG		H264			
D1	25 FPS		4CH/8CH & 16CH 25/50 FPS			
2 Cif	50 FPS		4CH/8CH & 16CH 50/100 FPS			
Cif	100 FPS		4CH/8CH & 16CH 100/200 FPS			
Picture size	8 KB - 20 KB/Picture					
HDD settings	Linear/circular					
<b>Playback</b>						
Playback	Playback, stop, pause, Picture Forward/Rewind, Search					
Picture search	Yes(1×, 2×, ...32×)					
<b>Hard drives</b>						
Build in HDD	4/8/16 360Gb/500Gb/1Tb					
<b>Export</b>						
Unit	USB 2.0 And DVD/RW					
<b>Alarm</b>						
Alarm-input	× 4, Terminal (TTL)		× 8, Terminal (TTL)		× 16, Terminal (TTL)	
Alarm detection	N.C. / N.O.					
Audio alarm	Buzzer					
Motion detection	16 × 12					
Video loss detection	Yes					
Alarm-relay output	× 1 3,0 A / 30 VDC or 3,0 A / 125 VAC					
<b>Communication</b>						
Communications protocol	RS-485 DSCP					
Software	Remote Agent *					
IP camera support	ACTI, Axis, Sanyo, Sony					
Network connection	Ethernet RJ-45 plug, 10/100 Mbps, Supports DHCP					
LAN-remote	Internet Explorer Browser, Windows AP					
Dome camera protocol	Pelco P, Pelco D, AD422, Fastrax 2, Panasonic					
Remote	Monitor, Playback, Recording, system setup, Dome camera control					
<b>Display functions</b>						
Search	Based on time, event and calender					
Play/pause/REW/FF	Control of playback direction and speed					
User management	8 level user management					
<b>General</b>						
Measure (W x H x D)	362 × 90 × 350 mm/ shipping 410x210x500					
Weight	5,5 kg/7kg shipping					
Operating temperature	0 °C ~ 40 °C					
Power consumption	19 W**	50W	30 W**	61W	34 W**	65W
Humidity	5 % - 85 %					
Order number	0063-08300	0063-08305	0063-08310	0063-08315	0063-08320	0063-08325
<b>Accessories</b>						
Keyboard	0017-05230					
Balun with Plug/ UTP version	0618-00210					
Balun No Plug/ UTP Version	0618-00211					
Monitor	0081-00020					
Extra 1 TB Hard Drive	0616-00216					
USB Key 4 GB	0063-07519					

\* Recommended software/hardware: Windows 2000, Xp or Vista, Intel PIII or better, 512 MB RAM (1 GB RAM or more recommended)  
Microsoft Internet Explorer 6.0 SP2, LAN- \*\*External Power supply

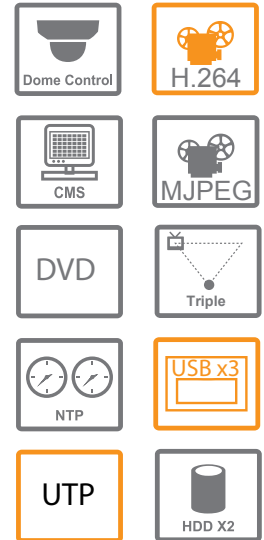

CMS



Your Video Surveillance supplier

Ernitec A/S  
Phone: +45 44 50 33 00  
Fax: +45 44 50 33 33  
info@ernitec.dk

Ernitec UK  
Phone: +44 (0) 1903 263 125  
Fax: +44 (0) 1903 263 126  
info@ernitec.co.uk

Ernitec SARL  
Phone: +33 (0)4 67 15 10 15  
Fax: +33 (0)4 67 64 01 81  
info@ernitec.fr

Ernitec GmbH  
Phone: +49(0)(40) 6756250  
Fax: +49(0)(40) 67562525  
info@ernitec.de

**ernitec**